

RPL Series

Features

- 105°C, 5,000 hours assured
- 10 φ ~ 18 φ with large permissible ripple current
- Slim type included
- RoHS compliance



Specifications

Items	Performance																								
	Category Temperature Range	400V -40°C ~ +105°C		420 ~ 450V -25°C ~ +105°C																					
Capacitance Tolerance	±20% (at 120 Hz, 20°C)																								
Leakage Current (at 20°C)	<table border="1"> <thead> <tr> <th>Time</th> <th colspan="4">after 5 minutes</th> </tr> </thead> <tbody> <tr> <td>Leakage Current</td> <td>CV ≤ 1,000 I = 0.03CV + 15(µA)</td> <td colspan="2">CV > 1,000 I = 0.02CV + 25(µA)</td> <td></td> </tr> </tbody> </table> <p>Where, C = rated capacitance in µF, V = rated DC working voltage in V</p>					Time	after 5 minutes				Leakage Current	CV ≤ 1,000 I = 0.03CV + 15(µA)	CV > 1,000 I = 0.02CV + 25(µA)												
Time	after 5 minutes																								
Leakage Current	CV ≤ 1,000 I = 0.03CV + 15(µA)	CV > 1,000 I = 0.02CV + 25(µA)																							
Tanδ (at 120 Hz, 20°C)	<table border="1"> <thead> <tr> <th>Rated Voltage</th> <th>400</th> <th>420</th> <th colspan="2">450</th> </tr> </thead> <tbody> <tr> <td>Tanδ (max)</td> <td>0.24</td> <td>0.24</td> <td colspan="2">0.24</td> </tr> </tbody> </table>					Rated Voltage	400	420	450		Tanδ (max)	0.24	0.24	0.24											
Rated Voltage	400	420	450																						
Tanδ (max)	0.24	0.24	0.24																						
Low Temperature Characteristics (at 120 Hz)	<p>Impedance ratio shall not exceed the values given in the table below.</p> <table border="1"> <thead> <tr> <th colspan="2">Rated Voltage</th> <th>400</th> <th>420</th> <th colspan="2">450</th> </tr> </thead> <tbody> <tr> <td rowspan="2">Impedance Ratio</td> <td>Z(-25°C)/Z(+20°C)</td> <td>5</td> <td>6</td> <td colspan="2">6</td> </tr> <tr> <td>Z(-40°C)/Z(+20°C)</td> <td>6</td> <td>-</td> <td colspan="2">-</td> </tr> </tbody> </table>					Rated Voltage		400	420	450		Impedance Ratio	Z(-25°C)/Z(+20°C)	5	6	6		Z(-40°C)/Z(+20°C)	6	-	-				
Rated Voltage		400	420	450																					
Impedance Ratio	Z(-25°C)/Z(+20°C)	5	6	6																					
	Z(-40°C)/Z(+20°C)	6	-	-																					
Endurance	<table border="1"> <thead> <tr> <th>Test Time</th> <th colspan="4">5,000 Hrs</th> </tr> </thead> <tbody> <tr> <td>Capacitance Change</td> <td colspan="4">Within ±20% of initial value</td> </tr> <tr> <td>Tanδ</td> <td colspan="4">Less than 200% of specified value</td> </tr> <tr> <td>Leakage Current</td> <td colspan="4">Within specified value</td> </tr> </tbody> </table> <p>* The above specifications shall be satisfied when the capacitors are restored to 20°C after the rated voltage applied with rated ripple current for 5,000 hours at 105°C.</p>					Test Time	5,000 Hrs				Capacitance Change	Within ±20% of initial value				Tanδ	Less than 200% of specified value				Leakage Current	Within specified value			
Test Time	5,000 Hrs																								
Capacitance Change	Within ±20% of initial value																								
Tanδ	Less than 200% of specified value																								
Leakage Current	Within specified value																								
Shelf Life Test	<table border="1"> <thead> <tr> <th>Test Time</th> <th colspan="4">1,000 Hrs</th> </tr> </thead> <tbody> <tr> <td>Capacitance Change</td> <td colspan="4">Within ±20% of initial value</td> </tr> <tr> <td>Tanδ</td> <td colspan="4">Less than 200% of specified value</td> </tr> <tr> <td>Leakage Current</td> <td colspan="4">Within specified value</td> </tr> </tbody> </table> <p>* The above specifications shall be satisfied when the capacitors are restored to 20°C after exposing them for 1,000 hours at 105°C without voltage applied. The rated voltage shall be applied to the capacitors before the measurements (Refer to JIS C 5101-4 4.1).</p>					Test Time	1,000 Hrs				Capacitance Change	Within ±20% of initial value				Tanδ	Less than 200% of specified value				Leakage Current	Within specified value			
Test Time	1,000 Hrs																								
Capacitance Change	Within ±20% of initial value																								
Tanδ	Less than 200% of specified value																								
Leakage Current	Within specified value																								
Ripple Current and Frequency Multipliers	<table border="1"> <thead> <tr> <th>Frequency (Hz)</th> <th>60</th> <th>120</th> <th>500</th> <th>1k</th> <th>10k up</th> </tr> </thead> <tbody> <tr> <td>Multipliers</td> <td>0.80</td> <td>1.00</td> <td>1.25</td> <td>1.40</td> <td>1.50</td> </tr> </tbody> </table>					Frequency (Hz)	60	120	500	1k	10k up	Multipliers	0.80	1.00	1.25	1.40	1.50								
Frequency (Hz)	60	120	500	1k	10k up																				
Multipliers	0.80	1.00	1.25	1.40	1.50																				

Diagram of Dimensions

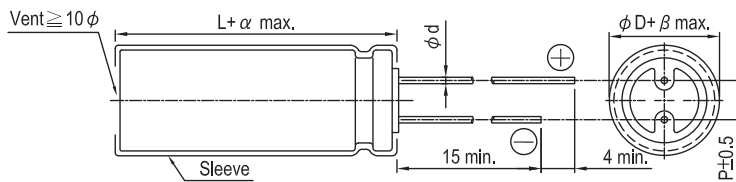

Lead Spacing and Diameter

φ D	10	12.5	16	18
P	5.0	5.0	7.5	7.5
φ d	0.6		0.8	
α	2.0			
β	0.5			

Unit: mm



Dimension: $\phi D \times L$ (mm)
Ripple Current: mA/rms at 105°C

Dimension and Permissible Ripple Current

Rated Voltage (V _{DC})	Cap. (μF)	10 φ				12.5 φ			16 φ			18 φ		
		φ D×L	Ripple Current		φ D×L	Ripple Current		φ D×L	Ripple Current		φ D×L	Ripple Current		
			120 Hz	100k Hz		120 Hz	100k Hz		120 Hz	100k Hz		120 Hz	100k Hz	
400V (2G)	33	10×35	320	480										
	39	10×40	380	570	12.5×30	380	570							
	47	10×45	425	638										
	56	10×50	490	735	12.5×35	475	713							
	68				12.5×40	550	825	16×31.5	530	795				
	82				12.5×45	615	923	16×35.5	605	908				
	100							16×40	740	1,110				
	120							16×45	795	1,193	18×35.5	730	1,095	
150							16×50	865	1,300	18×45	910	1,365		
420V (2P)	33	10×40	350	525										
	39	10×45	390	585	12.5×30	380	570							
	47	10×50	445	668	12.5×35	410	615							
	56				12.5×40	490	735	16×31.5	475	713				
	68				12.5×45	560	840	16×35.5	550	825				
	82				12.5×50	625	938	16×40	630	945				
	100							16×45	750	1,125	18×35.5	675	1,013	
	120							16×50	865	1,298	18×40	810	1,238	
150										18×45	825	1,215		
150										18×45	950	1,425		
150										18×50	950	1,425		
450V (2W)	33	10×45	315	475	12.5×30	350	525							
	39	10×50	360	545	12.5×35	400	600							
	47				12.5×40	425	683	16×31.5	455	683				
	56				12.5×45	500	750	16×35.5	560	750				
	68				12.5×50	540	810	16×40	590	885				
	82							16×35.5	530	795				
	100							16×45	675	1,013	18×35.5	645	968	
	120							16×50	785	1,178	18×40	740	1,110	
	150										18×35.5	685	1,025	
150										18×45	825	1,238		
150										18×40	790	1,185		
150										18×50	950	1,425		

Remark: Other sizes and specification are available, please contact us for detail.

Part Numbering System

RPL Series 33μF ±20% 450V Bulk Package Gas Type 10 φ ×45L Pb-free and PET sleeve

RPL **330** **M** **2W** **BK** - **1045**

Series Name Capacitance Capacitance Tolerance Rated Voltage Lead Configuration and Package Rubber Type Case Size Lead Wire and Sleeve type

Note: For more details, please refer to "Part Numbering System (Radial Type)" on page 13.

Radial